



SPARE PART LIST

| Spare Part ItemCode | Item name. | PictureId |
|------------------------|--|-----------|
| 6232.00004.15 | MAGNET FOR DOOR 25x5x5mm NEODIUM | 15 |
| 9099.00A60.00 | GAS VALVE MAX-MIN ADJUSTMENT PILOT OUTPUT WITH THERMOCOUPLE SAFE 21S | 17 |
| 6260.00015.46 | THERMOPLASTIC KNOB MAIN BODY WITH 8 mm INSERT | 18 |
| 6260.00015.40 | THERMOPLASTIC KNOB SCALE MAX.-MIN FLAME-LIGHTING | 19 |
| 6260.00058.96 | FLUE COVER CAST IRON WITH CERAMIC ENAMEL COATED FOR ALL 700&900 | 2 |
| 2KLP.460.626700006.05 | MAIN BURNER NOZZLE M8x0,75 ANY GAS TYPE | 24 |
| 6267.00002.046 | BURNER ASSEMBLY 10 Kw FOR 900 SERIES GAS COOKERS | 26 |
| 6267.00020.51 | PILOT ASSEMBLY SHORT | 3 |
| 6260.00002.10 | ADJUSTABLE FEET | 3 |
| 6267.00002.048 | BURNER ASSEMBLY 6 Kw FOR 900 SERIES GAS COOKERS | 33 |
| 2179.09028.01 | LABEL FOR FRONT PANEL "ÖZT RYAK LER" | 34 |
| 6201.00007.07 | HINGE BALANCER FOR STATIC GAS OVEN DOOR 700-900 | 39 |
| 6267.00024.00 | THERMOCOUPLE 9/1 600 mm LENGTH | 4 |
| 6260.00002.10 | ADJUSTABLE FEET | 43 |
| 6260.00058.43 | PAN SUPPORT CAST IRON W CERAMIC ENAMEL COATED FOR 900 SERIES COOKERS | 5 |
| 6201.00007.06 | HINGE FOR STATIC GAS OVEN DOOR-LEFT | 51 |
| 6260.00010.34 | OVEN DOOR HANDLE 538mm L 15x32mm CHROM COATED | 54 |
| 6201.00007.05 | HINGE FOR STATIC GAS OVEN DOOR-RIGHT 700-900 | 56 |
| 2865.N20.12000290.E.10 | FRONT PANEL FOR 12090 GAS COOKER WITH ELECTRICAL OVEN | 6 |
| 6230.00014.31 | CONTACTOR 220V 4KW | 62 |
| 6246.00025.17 | HEATING ELEMENT 2300 W 230 V FOR 80'S STATIC OVEN | 66 |
| 6246.00025.18 | HEATING ELEMENT 3700 W 230 V FOR 80'S STATIC OVEN | 67 |
| 6254.00005.04 | 4 POLE ON-OFF SWITCH | 72 |
| 6260.00010.35 | DOOR HANDLE 310mm L 15x32mm CHROM COATED | 8 |
| 6232.00027.09 | 4 POS. SELECTOR SWITCH RTH C01 | 86 |
| 6234.00001.05 | THERMOSTAT 50-300 C MONOPHASE | 87 |
| 6259.00003.10 | CABLE GLAND PG 21 | 88 |
| 6267.00020.33 | PILOT BURNER ASSEMBLY LONG FOR 900 SERIES COOKERS | 90 |
| 6260.00015.45 | THERMOPLASTIC KNOB MAIN BODY WITH 6 mm INSERT | 91 |
| 6260.00015.49 | THERMOPLASTIC KNOB SCALE WITH "O" MARKED FOR "OK" | 92 |
| 6260.00015.32 | THERMOPLASTIC KNOB SCALE 50-300 C | 93 |



DİKKAT: BU DÖKÜMANIN COĞALTILMASI, İNTERNET ORTAMINDA DOLAŞTIRILMASI VE BU ÇİZİMLER DOĞRULUĞUNDA ÜRETİMİN YAPILMASI ÖZTİRYAKLER FİRMASININ ONAYI İLE OLABİLİR. TÜM HAKLARIMIZ SAKLIDIR.

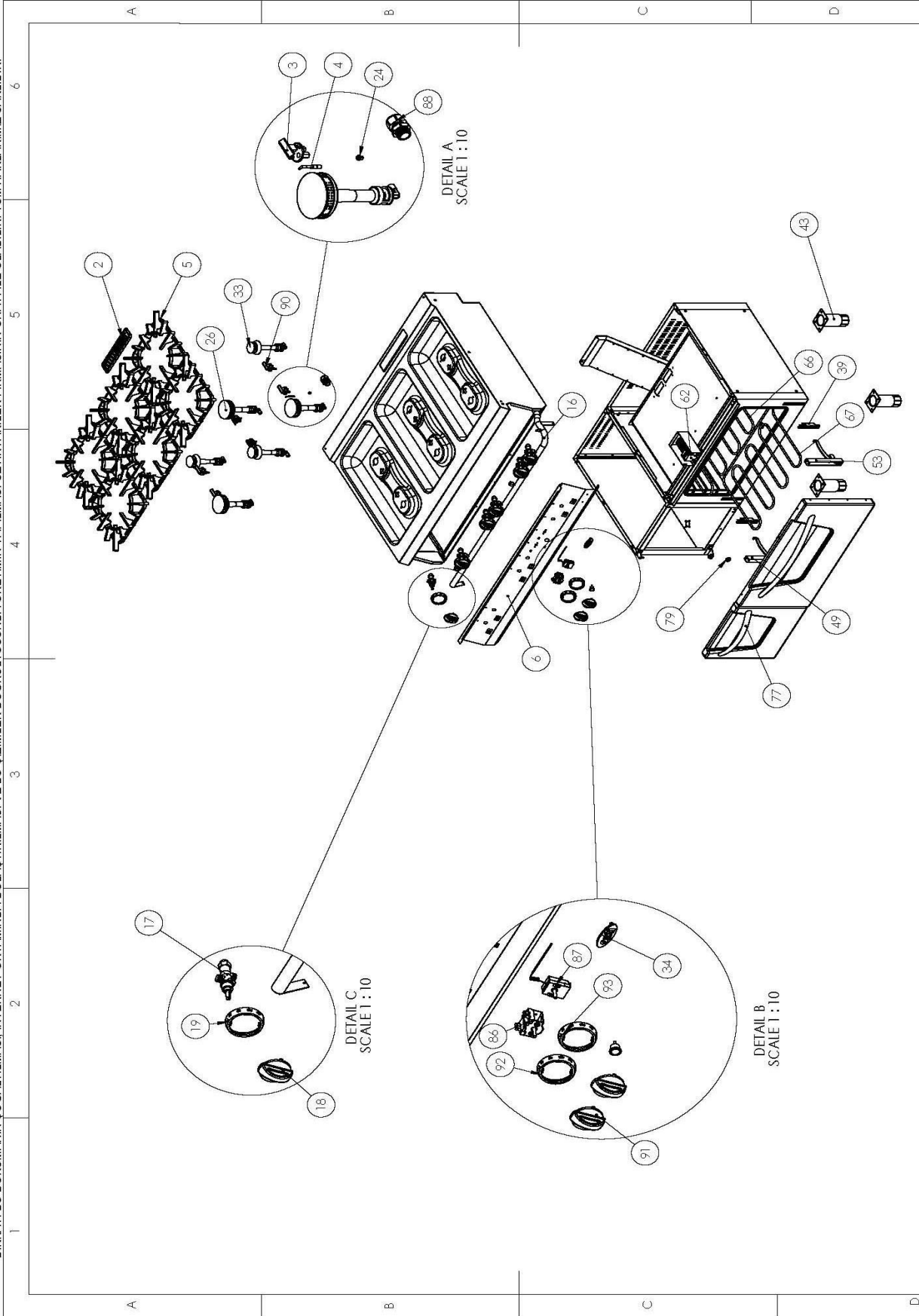

Öztiryakler

6 gazlı ocaklı elektrikli kuzine

| RİSD | BİM | İMZA | TARİHİ | MATERYAL | TOLERANS |
|--------------|-----------|----------|------------|----------|-----------------------|
| ÇİZEN | E.BAŞTUĞ | | 22.12.2012 | | DIN 71 68 |
| KONTROL | M.HACI | | 22.12.2012 | | ORTA |
| ONAY | M.HACI | | 22.12.2012 | | |
| AGIRLIK(Gr.) | 153883,16 | KALINLIK | REVİZYON | 1 | ÖLÇEK |
| | | | | | 1:50 |
| | | | | | T. RESİM NO |
| | | | | | OSOGEF 12090 patlamış |

ARGE
KONTROLLÜ KOPYA

V13.01

RESİM ÜZERİNDEN ÖLÇÜ ALMAYINIZ! TÜM ÖLÇÜLER mm ÇİNSİNDİR

WARNING: IT IS APPROPRIATE TO MULTIPLY, USE, DISPLAY AT COMPUTER/INTERNET AND PRODUCE THE PRODUCT WITH ITS DRAWINGS WITH THE APPROVAL OF ÖZTİRYAKLER COMPANY. ALL RIGHTS RESERVED.